



FLATPLATE

PREMIUM SCREWLESS FINISHES



www.bgelectrical.uk



Flatplate Screwless Wiring Accessories

Our slimline screwless accessories are available in three stocked finishes: brushed steel, polished chrome and black nickel.

For specification projects, any finish can be created to suit the environment, for example matt black, pearl nickel, cream and antique brass. Products within the range include standard switches and sockets, USB sockets, shaver sockets, dimmer switches, double pole switches and telephone and data outlets.

Flatplate is available in four stocked finishes:



IN THE RANGE

USB Sockets	4
Switches & Sockets	5
FCUs	6
Co-axial / Sat / Tel / Data	7
Dimmer Switches	8
Shaver Sockets	9
Blank Plates	10
Euro Module Plates	10
Accessories	10



BG Electrical products are guaranteed against faulty materials and workmanship for a period of 25 years from date of delivery.

Features & Benefits

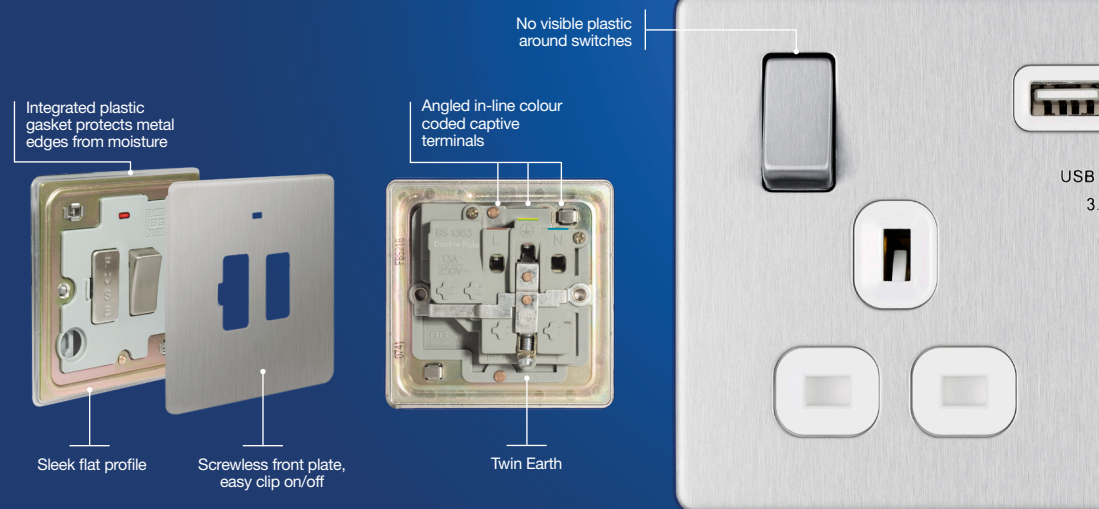

13 Amp Switched Socket with USB Charger 2 X Outlets 2.1A

- Ideal for charging smartphones, tablets, cameras and more
- Terminal capacity 3 x 2.5mm², 3 x 4.0mm² & 2 x 6.0mm²
- 35mm box required (supplied with optional 10mm spacer for 25mm box retrofit)
- Twin earth fitted as standard – Ref. BS 7671:2008
- Manufactured to BS1363-2
- 10 year guarantee



FPC21U2W



FBN21U2B

Brushed Steel	Polished Chrome	Black Nickel	Description	Inner Carton	Outer Carton
FBS21U2W	FPC21U2W	-	Single switched socket + 2 x USB (2.1A), white insert	5	50
FBS21U2G	-	-	Single switched socket + 2 x USB (2.1A), grey insert	5	50
-	-	FBN21U2B	Single switched socket + 2 x USB (2.1A), black insert	5	50



13 Amp Switched Socket with USB Charger 2x Outlets 3.1A

- Ideal for charging smartphones, tablets, cameras and more
- Terminal capacity 3 x 2.5mm², 3 x 4.0mm² & 2 x 6.0mm²
- 35mm box required (supplied with optional 10mm spacer for 25mm box retrofit)
- Twin earth fitted as standard – Ref. BS 7671:2008
- Manufactured to BS1363-2
- 10 year guarantee



FPC22U3G

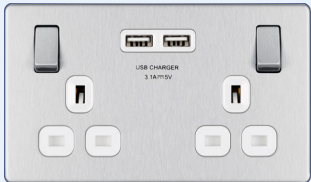

FBS22U3W

Brushed Steel	Polished Chrome	Black Nickel	Description	Inner Carton	Outer Carton
FBS22U3W	FPC22U3W	-	Double switched socket + 2 x USB (3.1A), white insert	5	50
FBS22U3G	FPC22U3G	-	Double switched socket + 2 x USB (3.1A), grey insert	5	50
-	-	FBN22U3B	Double switched socket + 2 x USB (3.1A), black insert	5	50



13 Amp Switched Socket with USB Charger 4x Outlets 4.2A

- Ideal for charging smart phones, tablets, cameras and more
- Terminal capacity 3 x 2.5mm², 3 x 4.0mm² & 2 x 6.0mm²
- 35mm box required (supplied with optional 10mm spacer for 25mm box retrofit)
- Twin earth fitted as standard – Ref. BS 7671:2008
- Manufactured to BS1363-2
- 10 year guarantee



FPC24U44W



FBN24U44B

Brushed Steel	Black Nickel	Description	Inner Carton	Outer Carton
FBS24U44G	FBN24U44B	Double socket + 4 x USB (4.2A)	5	50

13 Amp Switched Socket with USB Charger

- 22W & 45W outputs offer fast charge with variable voltage
- Ideal for charging smart phones, tablets, cameras and more
- Terminal capacity 3 x 2.5mm², 3 x 4.0mm² & 2 x 6.0mm²
- 35mm box required (supplied with optional 10mm spacer for 25mm box retrofit)
- Twin earth fitted as standard – Ref. BS 7671:2008
- Manufactured to BS1363-2
- 10 year guarantee



FFB22UAC22B



FFB22UAC45B

Matt Black	Description	Inner Carton	Outer Carton
FFB22UAC22B	Double socket + USB A x 1 + USB C x 1 (22W)	5	50
FFB22UAC45B	Double socket + USB A x 1 + USB C x 1 (45W)	5	50



13 Amp Socket Outlets

- Twin earth fitted as standard to allow a double earth facility for installations requiring high integrity protective connection Ref. BS 7671:2008
- Manufactured to BS 1363 Part 2
- Minimum mounting box depth 25mm
- Terminal capacity 3 x 2.5mm², 3 x 4.0mm² & 2 x 6.0mm²

*Insert colours = White (W), Grey (G) and Black (B) at the end of the product code



FPC21W



FBS21G

Brushed Steel	Polished Chrome	Black Nickel	Matt Black	Description	Inner Carton	Outer Carton
FBS21G	FPC21G	FBN21B	FFB21B	Single switched socket	5	50
-	FPC21W	-	-	Single switched socket	5	50
FBS22G	FPC22G	FBN22B	FFB22B	Double switched socket	5	50
-	FPC22W	-	-	Double switched socket	5	50
FBS23G*	FPC23G*	FBN23G*	FFB23B*	Single unswitched socket	EM	-
-	FPC23W*	-	-	Single unswitched socket	EM	-
FBS24G*	FPC24G*	FBN24G*	FFB24B*	Double unswitched socket	EM	-
-	FPC24W*	-	-	Double unswitched socket	EM	-



20 Amp 16AX Switches

- Captive terminal screws
- Terminal capacity 4 x 1.0mm², 4 x 1.5mm², 2 x 2.5mm² & 1 x 4.0mm²
- Plate switches manufactured to BS EN 60669-1, fan isolator to IEC 60669-2-4
- Minimum mounting box depth:
 - Single and double 16mm
 - Triple and quadruple 25mm

*Bell push switch available made to order, contact Customer Services for details



FPC15

Brushed Steel	Polished Chrome	Black Nickel	Matt Black	Description	Inner Carton	Outer Carton
FBS12	FPC12	FBN12	FFB12	Single, 2 way	5	50
FBS13	FPC13	FBN13	FFB13	Intermediate	5	50
FBS42	FPC42	FBN42	FFB42	Double, 2 way	5	50
FBS43	FPC43	FBN43	FFB43	Triple, 2 way	5	50
FBS44	FPC44	FBN44	FFB44	Quadruple, 2 way	5	50



FBN43



FFB12

10 Amp 3 Pole Fan Isolator

- 10 Amp, triple pole
- Captive terminal screws
- Terminal capacity 4 x 1.0mm², 4 x 1.5mm², 2 x 2.5mm² & 1 x 4.0mm²
- Manufactured to IEC 60669-2-4
- Minimum mounting box depth: 25mm



FPC15

Brushed Steel	Polished Chrome	Black Nickel	Matt Black	Description	Inner Carton	Outer Carton
FBS15	FPC15	FBN15	FFB15	3 pole fan isolator	5	50
FBS15F	FPC15F	FBN15F	FFB15F	3 pole fused fan isolator	5	50

10AX Toggle Switches

- Single and double
- Available for projects
- Subject to conditions



20 Amp Double Pole Switches

- 20 Amp
- Terminal capacity 3 x 2.5mm² 2 x 4.0mm² 1 x 6.0mm²
- Colour coded terminals with backed out angled screws
- Flush LED power indicator
- Manufactured to BS EN 60669-1
- Minimum mounting box depth 25mm



Brushed Steel	Polished Chrome	Black Nickel	Matt Black	Description	Inner Carton	Outer Carton
FBS31	FPC31	FBN31	FFB31	20A double pole with power indicator	5	50

Round Pin and Export Socket Outlets

- 2/5/15A Manufactured to BS 546
- Mounting box depth:
13A and 15A: 35mm, 2A, 5A and 16A: 25mm

*Insert colours = White (W), Grey (G) and Black (B)
at the end of the product code



Brushed Steel	Polished Chrome	Black Nickel	Matt Black	Description	Inner Carton
FBS28G	FPC28W	FBN28B	FFB28B*	2 Amp unswitched socket round pin	EM
FBS29G	FPC29G	FBN29B	FFB29B	5 Amp unswitched socket round pin	EM
-	FPC29W	-	-	5 Amp unswitched socket round pin	EM
FBS99G	FPC99G	FBN99B	-	Single, 15 Amp switched socket	EM
FBS98G	-	-	-	Double, 16 Amp unswitched Euro socket	EM

13 Amp Fused Connection Units

- Manufactured to BS 1363 Part 4
- Angled colour coded terminals with captive screws
- Minimum mounting box depth 35mm
- Terminal capacity 3 x 2.5mm², 2 x 4.0mm² & 1 x 6.0mm²
- Supplied with pre-fitted 13 Amp fuse



Brushed Steel	Polished Chrome	Black Nickel	Matt Black	Description	Inner Carton	Outer Carton
FBS50	FPC50	FBN50	FFB50	13 Amp switched	5	50
FBS52	FPC52	FBN52	FFB52	13 Amp switched with power indicator	5	50
FBS53	FPC53	FBN53	FFB53	13 Amp switched with power indicator and cable outlet	5	50
FBS54	FPC54	FBN54	FFB54	13 Amp unswitched	5	50
FBS55	FPC55	FBN55	FFB55	13 Amp unswitched with power indicator and cable outlet	5	50

45 Amp Double Pole Switches

- Cooker Control Units manufactured to BS4177, Double Pole Switches to BS EN 60669-1
- L & N terminal capacity 4 x 4.0mm², 3 x 6.0mm² & 1 x 16.0mm²
- Minimum mounting box depth 47mm

*Insert colours = White (W), Grey (G) and Black (B)
at the end of the product code

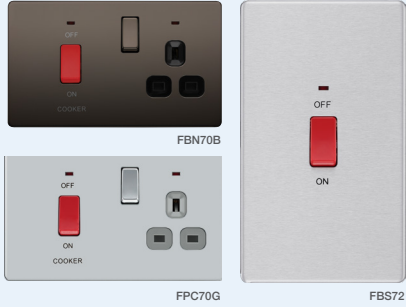

Brushed Steel	Polished Chrome	Black Nickel	Matt Black	Description	Inner Carton	Outer Carton
FBS70G	FPC70G	FBN70B	FFB70B	With 13 Amp socket and power indicator	5	50
-	FPC70W	-	-	With 13 Amp socket and power indicator	5	50
FBS72	FPC72	FBN72	FFB72	Double plate, with power indicator	5	50
FBS74	FPC74	FBN74	FFB74	Single plate, with power indicator	5	50

Fan Controller

- Manufactured to BS EN 60669-2-1
- Minimum mounting box depth 35mm
- 4 speed
- Rotary control



Brushed Steel	Polished Chrome	Black Nickel	Description	Inner Carton	Outer Carton
FBS87	FPC87	FBN87	Single, 1 rotary, 100W (export only)	5	50

Co-Axial and Satellite Sockets

- EM = Euro Module configuration *Supplied as kit of Euro Module components
- TV/FM mounting box depth 25mm, Triplex 35mm
- Insert colours – Polished Chrome = White, Brushed Steel = Grey



Brushed Steel	Polished Chrome	Black Nickel	Matt Black	Description	Inner Carton	Outer Carton
FBS60	FPC60	FBN60	FFB60	Co-Axial socket, single	5	50
FBS61*	FPC61*	FBN61*	FFB61*	Co-Axial socket, double	EM	-
FBS62*	FPC62*	FBN62*	FFB62*	Isolated co-axial socket, single	EM	-
FBS63*	FPC63*	FBN63*	FFB63*	Isolated co-axial socket, double	EM	-
FBS64*	FPC64*	FBN64*	FFB64*	Satellite socket, single	EM	-
FBS65*	FPC65*	FBN65*	FFB65*	Isolated co-axial socket, double	EM	-
FBS66*	FPC66*	FBN66*	FFB66*	Diplex TV/FM socket, double	EM	-
FBS67*	FPC67*	FBN67*	FFB67*	Triplex TV/FM/Satellite – screened	EM	-
FBS68*	FPC68*	FBN68*	FFB68*	Triplex TV/FM/Satellite + return and single, Tel – screened	EM	-
FBS69*	FPC69*	FBN69*	FFB69*	Quadplex TV/FM/Satellite (X2) + return and single, Tel – screened	EM	-

- See our Euro Module range for further Telecom, Data and Co-axial options

Telephone and Data Outlet

- Minimum mounting box depth 35mm
 - Manufactured to BS 6312 Part 2 where applicable
 - Modules available to make up any combination of RJ11, BT and RJ45
- *Supplied as kit of Euro Module components



Brushed Steel	Polished Chrome	Black Nickel	Matt Black	Description	Inner Carton	Outer Carton
FBSBTM1	FPCBTM1	FBNBTM1	FFBBTM1*	Telephone master, single	5	50
FBSBTM2*	FPCBTM2*	FBNBTM2*	FFBBTM2*	Telephone master, double	EM	-
FBSBTS1	FPCBTS1	FBNBTS1	FFBBTS1*	Telephone secondary, single	5	50
FBSBTS2*	FPCBTS2*	FBNBTS2*	FFBBTS2*	Telephone secondary, double	EM	-
FBSRJ111	FPCRJ111	FBNRJ111	FFBRJ111*	RJ11 socket, single	5	50
-	FPCRJ112*	FBNRJ112*	FFBRJ112*	RJ11 socket, single	EM	-
FBSRJ451	FPCRJ451	FBNRJ451	FFBRJ451	RJ45 data outlet socket, single	5	50
FBSRJ452*	FPCRJ452*	FBNRJ452*	FFBRJ452*	RJ45 data outlet socket, double	EM	-

- See our Euro Module range for further Telecom, Data and Co-axial options

Dimmer Switch – Intelligent Trailing Edge, Push Type

- Intelligent trailing edge dimmer suitable for LED, halogen, CFL and incandescent lamps
- Soft start, smooth dimming control and silent operation
- 2 Way push on/off with rotary control
- Overload protection
- Clearly marked terminals with backed out captive screws for easy installation
- Terminal capacity 3 x 1mm², 2 x 1.5mm² & 1 x 2.5mm²
- Manufactured to BS EN 60669-2-1
- Minimum mounting box depth 25mm
- 200-250V AC



Brushed Steel	Polished Chrome	Black Nickel	Matt Black	Description	Inner Carton	Outer Carton
FBS81	FPC81	FBN81	FFB81	Single, 2 way, push on/off (20-200W/5-100W LED)	5	50
FBS82	FPC82	FBN82	FFB82	Double, 2 way, push on/off (20-200W/5-100W LED)	5	50
FBS83	FPC83	FBN83	FFB83	Triple, 2 way, push on/off (20-200W/5-100W LED)	5	50
FBS84	FPC84	FBN84	FFB84	Quadruple, 2 way, push on/off (20-200W/5-100W LED)	5	50

Shaver Socket

- Terminal capacity 3 x 2.5mm² & 2 x 4.0mm²
 - Minimum mounting box depth 47mm
 - Manufactured to BS EN 61558-1 and BS EN 61558-2-5
- *Insert colours = White (W), Grey (G) and Black (B) at the end of the product code

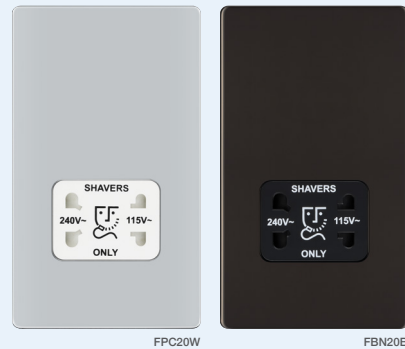

Brushed Steel	Polished Chrome	Black Nickel	Matt Black	Description	Inner Carton	Outer Carton
FBS20G	FPC20W	FBN20B	FFB20	115/240V dual voltage	5	30
-	FPC20G	-	-	115/240V dual voltage	5	30

Blank Plates

- Manufactured to BS 5733
- Fitted with Earth terminal
- Ideal for safely covering unused electrical connections



Brushed Steel	Polished Chrome	Black Nickel	Matt Black	Description	Inner Carton	Outer Carton
FBS94	FPC94	FBN94	FFB94	Single	5	50
FBS95	FPC95	FBN95	FFB95	Double	5	50

Euro Module Front Plates

- Fitted with Earth terminal

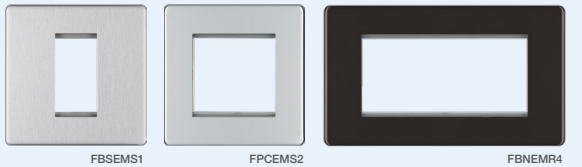

Brushed Steel	Polished Chrome	Black Nickel	Matt Black	Description	Inner Carton	Outer Carton
FBSEMS1	FPCEMS1	FBNEMS1	FFBEMS1	Single Euro module, single plate	10	100
FBSEMS2	FPCEMS2	FBNEMS2	FFBEMS2	Twin Euro module, single plate	10	100
FBSEMR4	FPCEMR4	FBNEMR4	FFBEMR4	Quad Euro module, double plate	5	50

16 Amp Hotel Key Card Switch

- 50 x 50mm Euro module
- Load rating – 1800W for incandescent, 800W for fluorescent
- 30 second power-off delay
- Mounting box depth 47mm
- Colour coded terminals with backed-out captive screws
- Designed and manufactured to BS EN60669-4
- Saves energy and improves safety
- Power to the room will active when a key card inserted
- Locator LED ideal for night operation



*Supplied as kit of Euro Module components

*Insert colours = White (W), Grey (G) and Black (B) at the end of the product code

Brushed Steel	Polished Chrome	Black Nickel	Matt Black	Description	Inner Carton
FBSKYCSG*	FPCKYCSW*	FBNKYCSB*	FFBKYCSB*	16 Amp Hotel Key Card switch	EM

Spare Accessories

Product Code	Description	Inner Carton	Outer Carton
FPFS17/10	M3.5 x 17mm screws, pack of 10	100pks	1000
FPFS26/10	M3.5 x 26mm screws, pack of 10	100pks	1000
FPFS36/10	M3.5 x 17mm screws, pack of 10	100pks	1000

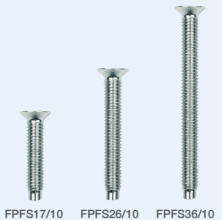

Euro Module Range Extension

Quick & Easy Installation

A flexible solution of power, data, telephone, television and audio combinations to suit the wide ranging needs of the customer.

- Select the desired combination of front plate and module(s)
- Simple installation, wire the module through the front plate aperture then push the module into place
- Modules of mains and extra low voltage rating must not be fitted to the same front plate aperture Ref. BS 7671:2008

Front Plate



SBSEMS2

Module



EMTVFMSATB

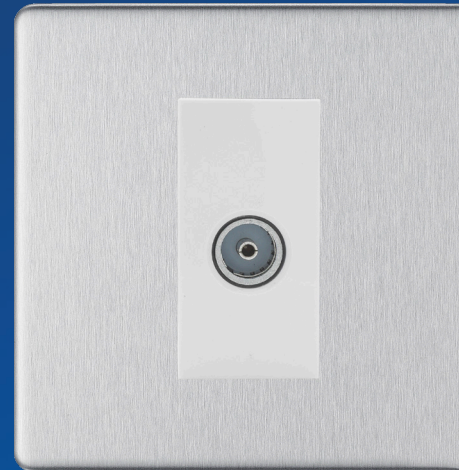

Grid Range Extension

Quick & Easy Installation

A customisable selection of power grid modules that provide a seamless appearance with the associated wiring accessories

- Firstly, screw the grid frame to the mounting box and wire the modules
- Then slot the module on to the frame and click into place
- Finally, fit the finished plate

Front Plate



RFPC2

Frame

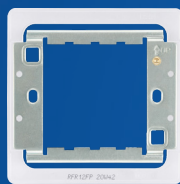

RFR12FP

Modules



R12



RFUSE

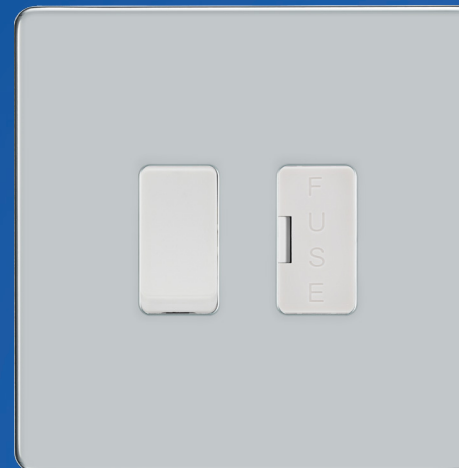

EVOLVE

DECORATIVE WIRING ACCESSORIES

Contemporary finishes for modern interiors



A new generation of modern wiring devices, available in the latest on trend colours and finishes

- Stand out or blend in with the widest choice of colours and finishes
- Complements any modern interior with a slim, stylish, screwless profile
- Enhanced functionality with fast charging USB's, WiFi extenders and LED touch dimmers
- Designed for easy installation

Find out more at www.evolve-bg.uk



UK:**HEAD OFFICE:**

Email: info@bgelectrical.uk

Luceco plc, Caparo House
103 Baker Street, London
England, W1U 6LN

DISTRIBUTION CENTRE:

Tel: +44 (0) 1952 238 100

Email: uk_sales@bgelectrical.uk

Luceco plc
Luceco Distribution Centre
Stafford Park 1, Telford
Shropshire, England, TF3 3BD

FRANCE:

Email: fr_sales@luceco.com

ITALY:

Email: it_sales@luceco.com

SPAIN:

Tel: +34 93 829 55 75

Email: es_sales@luceco.com

Nexus Industries LTD
C/ Bobinadora 1-5
08302 Mataró
Barcelona (SPAIN)

MIDDLE EAST & AFRICA:

Tel: +971 4 609 1867

Email: mea_sales@luceco.com

Luceco Middle East FZCO
Bldg. 5EB, Office 342
PO Box 371128, DAFZA
Dubai, UAE

ASIA PACIFIC:**JIAXING:**

Tel: +86 (0) 573 8357 0200

Email: asia_sales@luceco.com

No 1438, Jiachuang Road
Xiuzhou Industrial Park, Jiaxing
Zhejiang, China, P.C. 314031

HONG KONG:

Email: hk_sales@luceco.com

UNITED STATES:

Email: us_sales@luceco.com

MEXICO & LATIN AMERICA:

Tel: +52 (81) 5000 9437

Email: ventas@luceco.com

Luceco México
AV Lázaro Cárdenas #318 int 201
Col Real San Agustín
San Pedro Garza García
N.L. Mexico CP 66278

TECHNICAL SUPPORT:

Tel: 01952 238 128

Email: technical.support@bgelectrical.co.uk

Lines open Monday to Friday
8.30am to 5pm, with answer phone
service outside these hours.

LUCECO
G R O U P



www.bgelectrical.uk